

RIVER PARK WEST UNIT SEVEN SUBDIVISION IMPROVEMENTS

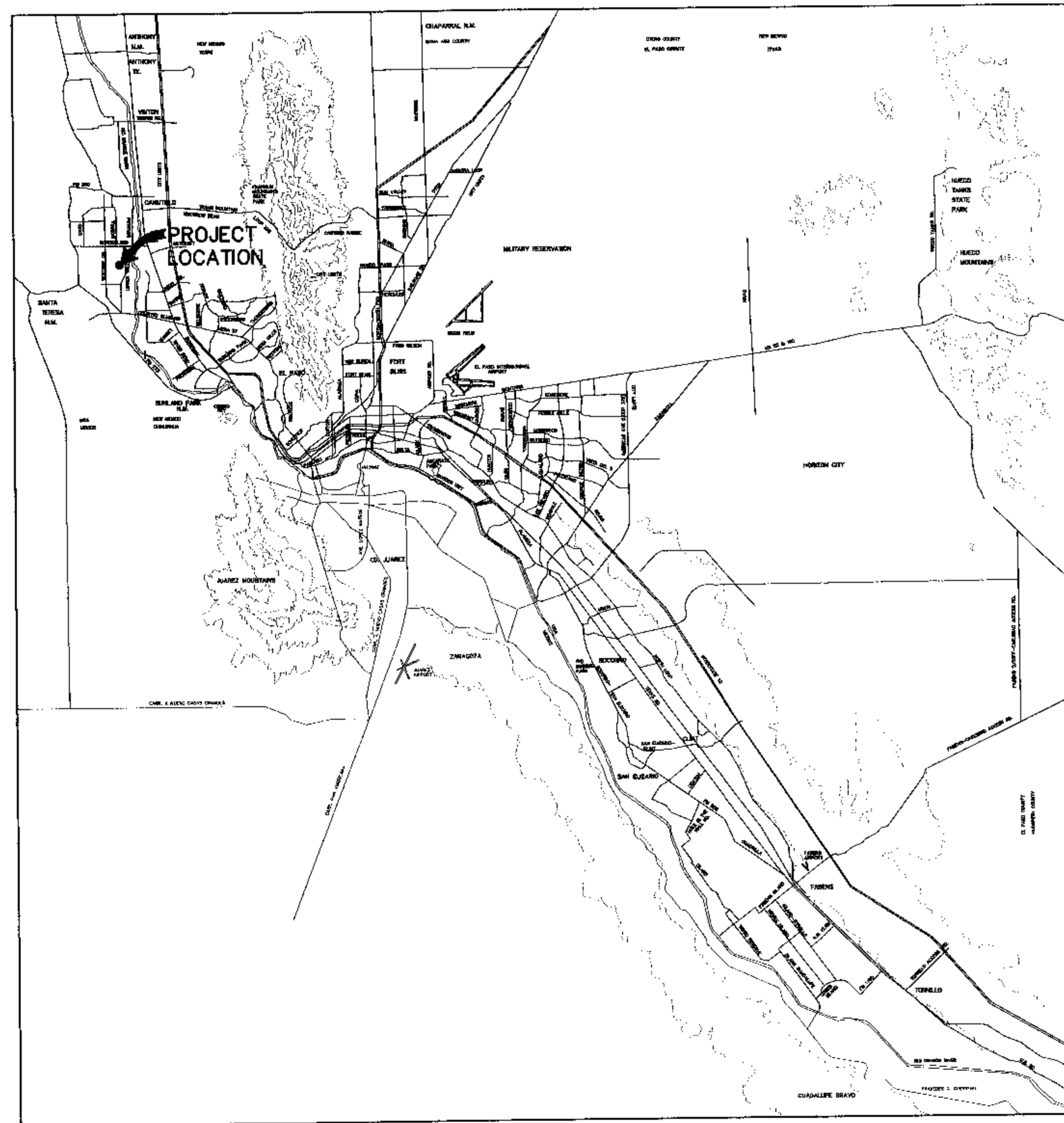

VICINITY MAP
APPROXIMATE SCALE:
1" = 2 MILES

DEVELOPER
R.P.W. DEVELOPMENT LTD.
7910 GATEWAY EAST SUITE 102
EL PASO, TEXAS 79915
(915) 591-6319
CONTACT: RANDY O'LEARY

CONSULTING ENGINEER



1204 Montana Ave., El Paso, Texas 79902
Office 915.544.5232 Fax 915.544.5233
www.coagroup.net

CONTACT: MR. JORGE L. AZCARATE, P.E.

LOCATION MAP SCALE: 1"=600'

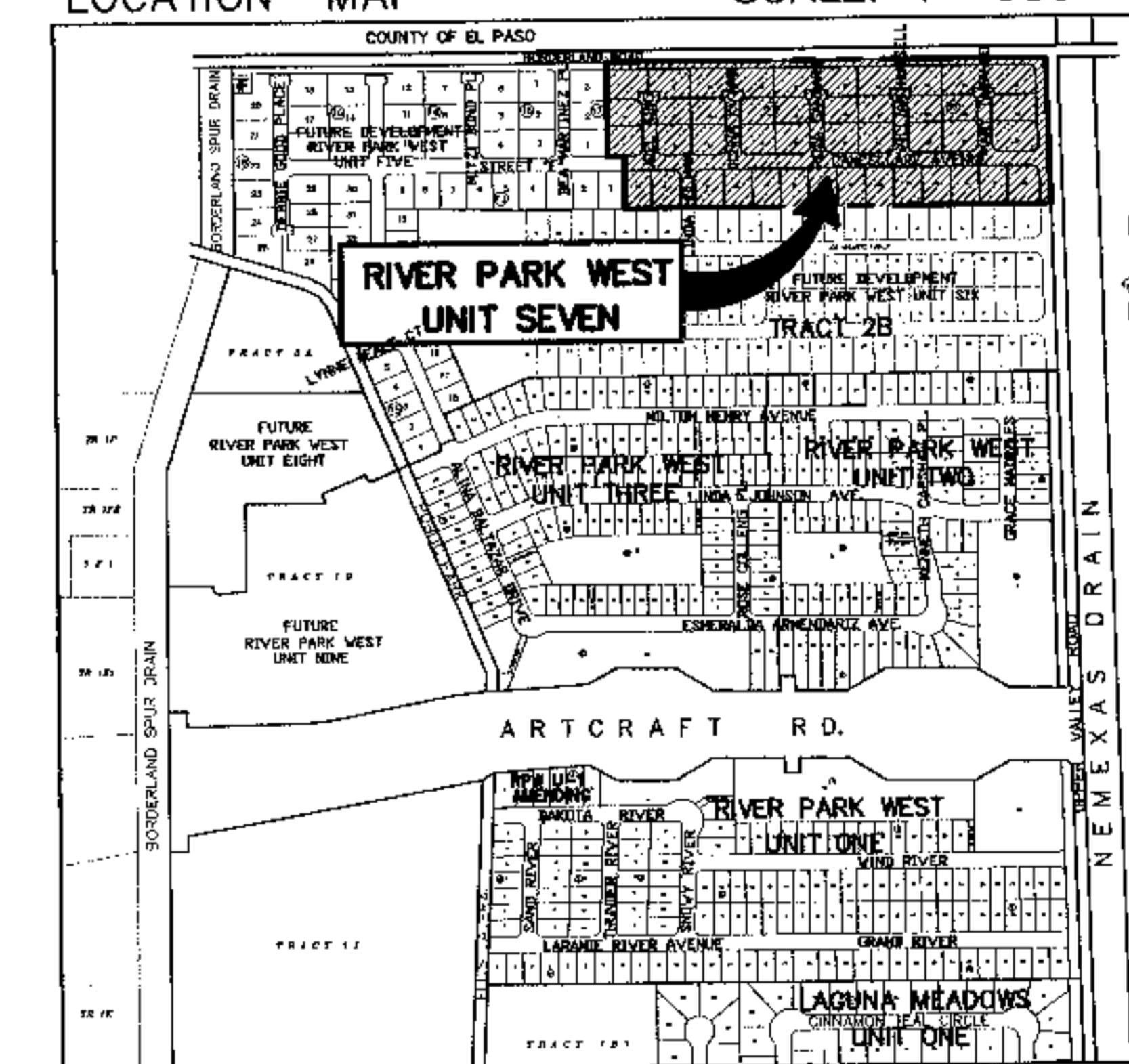

DEVELOPMENT SERVICES DEPARTMENT

THE CITY IS NOT PRECLUDED FROM IMPOSING REQUIREMENTS THAT MAY ARISE UPON FURTHER REVIEW OF THE PLANS

DEVELOPMENT SERVICES DEPARTMENT

Reviewing by the City of El Paso shall neither constitute approval nor have responsibility of the adequacy of design and plans.

DEVELOPMENT SERVICES DEPARTMENT

SITE PLAN REVIEW
Reviewed For Conformance For Conditions Related To:

- Demolition Only
- Grading & Drainage
- Wheelchair Ramps
- On Site Parking Layout
- Sidewalks
- Driveways
- Retaining Rock Walls
- On-Site Funding of Storm Water

Contractor Must Call 24 Hours Prior To Construction

BY *[Signature]*

LOCATION MAP
APPROXIMATE SCALE:
1" = 600'