

LLAMAS SUBDIVISION

CITY OF EL PASO, EL PASO COUNTY, TEXAS

DEVELOPMENT SERVICES DEPARTMENT
 Reviewing by the City of El Paso shall neither constitute approval nor have responsibility of the adequacy of design and plans.

DEVELOPMENT SERVICES DEPARTMENT
SITE PLAN REVIEW
 Reviewed For Conformance For Conditions Related To:
 - Demolition Only
 - Grading & Drainage
 - Wheelchair Ramps
 - On-Site Parking Layout
 - Sidewalks
 - Driveways
 - Retaining Wall Walls
 - On-Site Ponding of Storm Waters
 Contractor Must Call 24 Hours Prior To Construction For Inspection
 BY: *Carla Jaloma* DATE: 01/23/2007

INDEX

DESCRIPTION	SHEET NO.
COVER SHEET	1
PLAT	2
GRADING PLAN	3
DRAINAGE PLAN	4
STORM WATER POLLUTION PREVENTION PLAN	5
SITE PLAN	6
SITE DETAIL PLAN	7

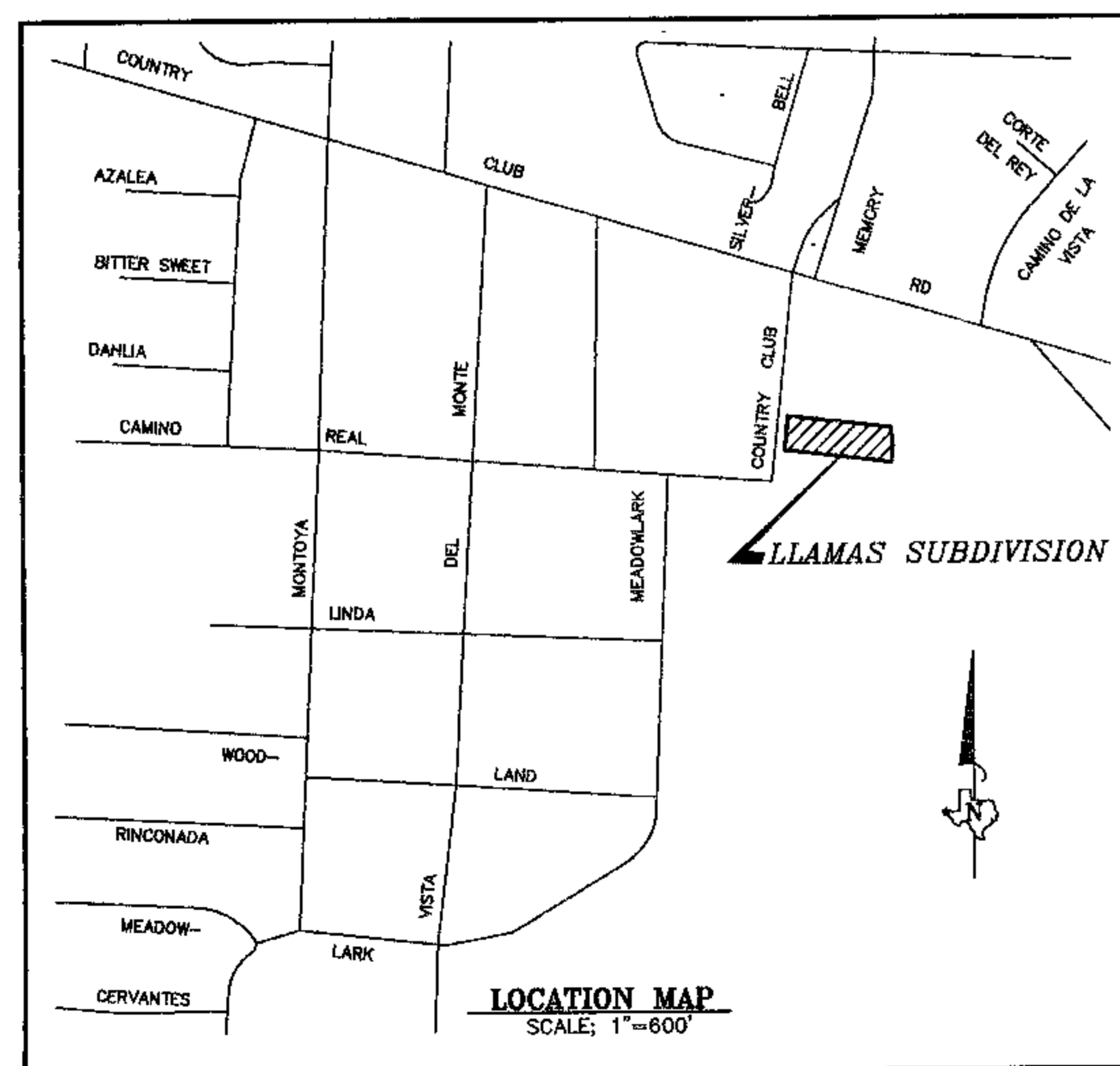

Mary Bell Haney
 MARY BELL HANEY
 Registered Professional Engineer, Texas No. 48816.

01/16/07

k KISTENMACHER ENGINEERING COMPANY, INC.
 CONSULTING ENGINEERING • LAND PLANNING • SURVEYING
 1420 GERONIMO DRIVE, SUITE A2 • EL PASO, TEXAS 79925 • 915-778-4476

REV. 1/15/07
 DATE: 12-18-2006 SHEET 1 OF 7