

HILLPOINT ESTATES UNIT SIX

SUBDIVISION IMPROVEMENTS

BEING TRACT 17-C-104 AND 17-C-103 SECTION 8, BLOCK 79,
TOWNSHIP 3, TEXAS AND PACIFIC RAILROAD SURVEY, AN ADDITION TO
THE CITY OF EL PASO, EL PASO COUNTY, TEXAS.
CONTAINING 1.835± ACRES

DEVELOPMENT SERVICES DEPARTMENT
SITE PLAN REVIEW
Reviewed For Conformance For Conditions Related To:
 - Driveways Only
 - Grading & Drainage
 - Wheelchair Access
 - On-Site Parking Layout
 - Sidewalks
 - Driveways
 - Recreational Walks
 - Outside Flowing of Storm Waters
 Construction Must Commence Within 90 Days Prior To Construction For
 BY: *Jorge Azcarate* DATE: 2/1/2008

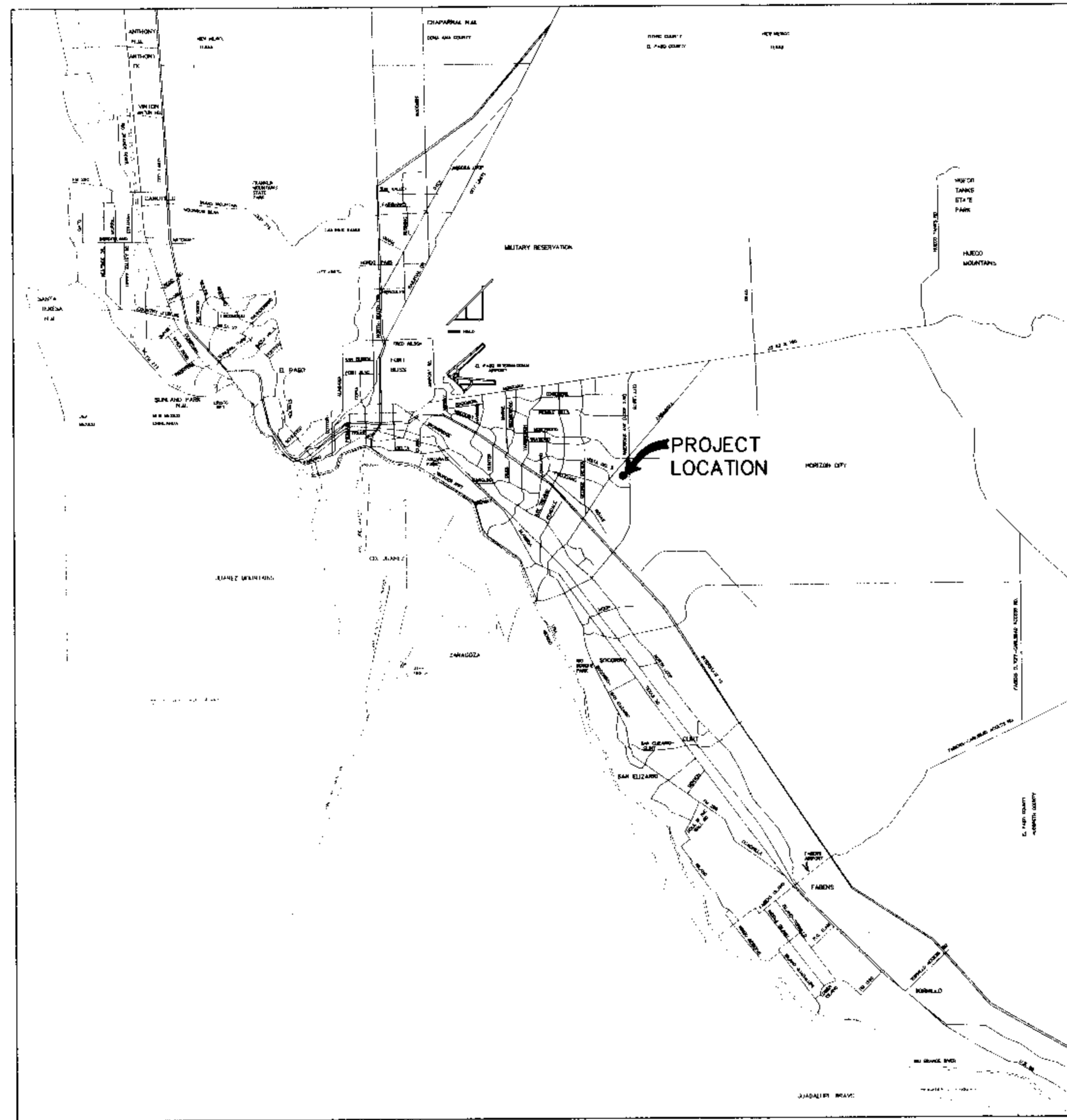

SHEET NUMBER	SHEET TITLE
CVR, 1	COVER SHEET, GENERAL INFORMATION
2	FINAL PLAT
3, 4	GRADING PLAN AND GRADING SECTIONS
4	DRAINAGE PLAN
6	STREET PLAN & PROFILES
7	STORM PLAN & PROFILES
8-9	STANDARD DETAILS
10	DRAINAGE DETAILS
11	ILLUMINATION PLAN
12-14	SWPPP

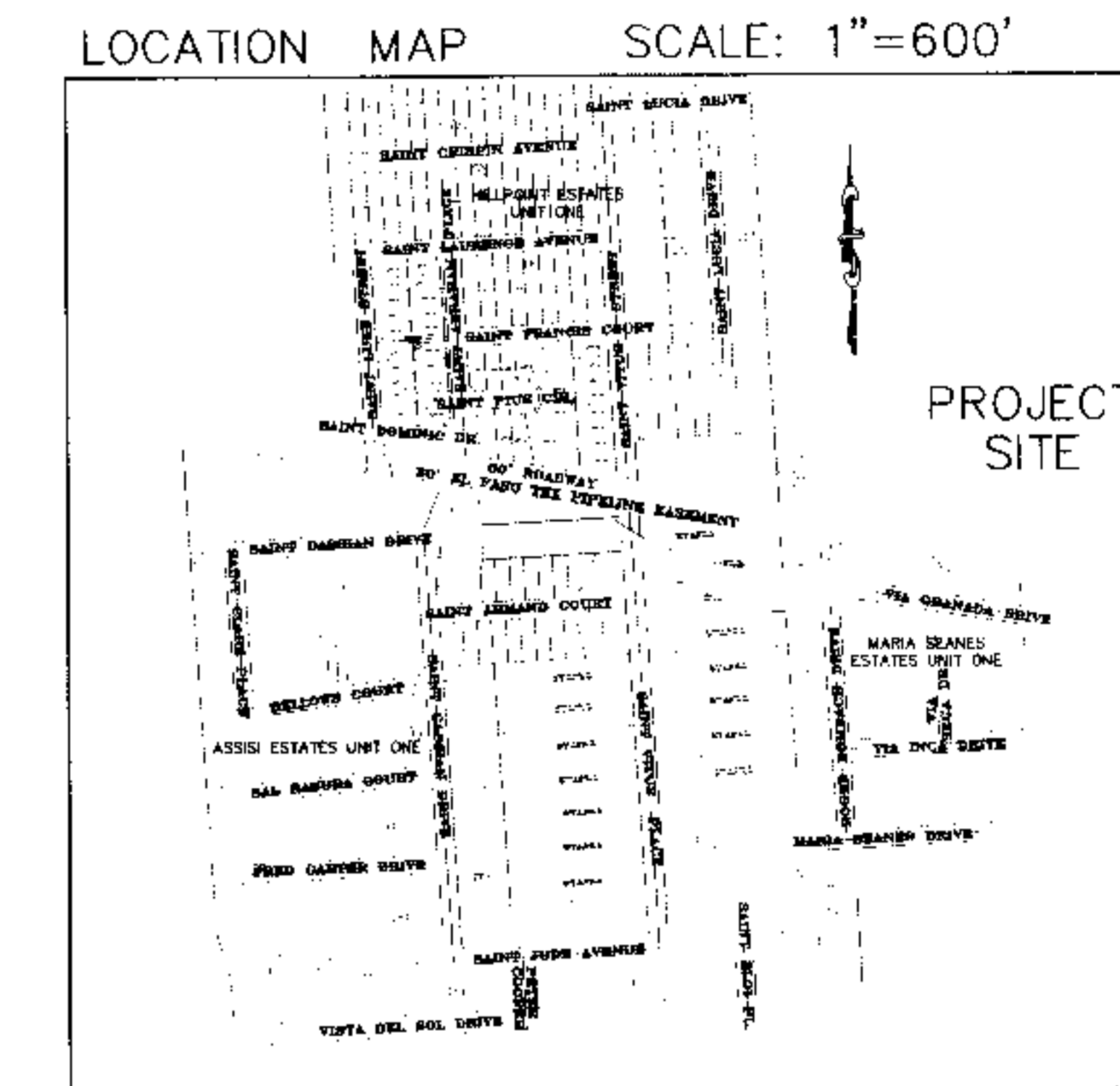

JORGE L. AZCARATE, P.E. PROJECT MANAGER



engineers • architects • planners
1204 Montana Ave., El Paso, Texas 79902
Office 915.544.5232 Fax 915.544.5233
www.ceagroup.net



LOCATION MAP
APPROXIMATE SCALE:
1" = 600'

VICINITY MAP
APPROXIMATE SCALE:
1" = 2 MILES

PRINCIPAL CONTACTS:

	NAME	ADDRESS	CITY & ZIP	PHONE	FAX
OWNER:	ELIA THOMPSON	10138 STONEWAY DR	EL PASO, 79925	(915) 598-1544	(915) 598-4221
ENGINEER:	CEA GROUP	1204 MONTANA AVE	EL PASO, 79902	(915) 544-5232	(915) 544-5233
SURVEYOR:	BARRAGAN & ASSOCIATES	1450 PENDALE ROAD SUITE B	EL PASO, 79936	(915) 591-5709	(915) 591-5706

HILLPOINT ESTATES UNIT SIX				
COVER SHEET				
DATE PREPARED	DRAWN BY:	DESIGN BY:	CHECKED BY:	APPROVED BY:
NOV 2007	D.N.	A.H.	J.L.A.	J.L.A.
REVISION NUMBER	SHEET NAME OR NUMBER	DESCRIPTION OF REVISION	DATE OF REVISION	REVISION APPROVED BY: