

# FRANKLIN VILLAGE UNIT TWO SUBDIVISION IMPROVEMENTS

## INDEX OF SHEETS

TITLE	SHEET NO.
-------	-----------

- |                         |      |
|-------------------------|------|
| COVER SHEET.....        | 1    |
| FINAL PLAT.....         | 2    |
| GRADING PLAN.....       | 3    |
| DRAINAGE PLAN.....      | 4    |
| POND DETAILS.....       | 5    |
| DRAINAGE STRUCTURE..... | 6    |
| STANDARD DETAILS.....   | 7, 8 |

### PLAN AND PROFILE:

- |  |    |
|--|----|
| ANTONIA ARCO CT. ....  | 9  |
| STORM WATER POLLUTION<br>PREVENTION PLAN DETAILS.....  | 10 |
| CONSTRUCTION POLLUTION<br>PREVENTION PLAN AND<br>SITE INFORMATION AND<br>SPECIFICATIONS..... | 11 |

### TYPICAL DETAILS:

- |                               |    |
|-------------------------------|----|
| ILLUMINATION PLAN.....        | 12 |
| ILLUMINATION DETAIL PLAN..... | 13 |

## VICINITY MAP

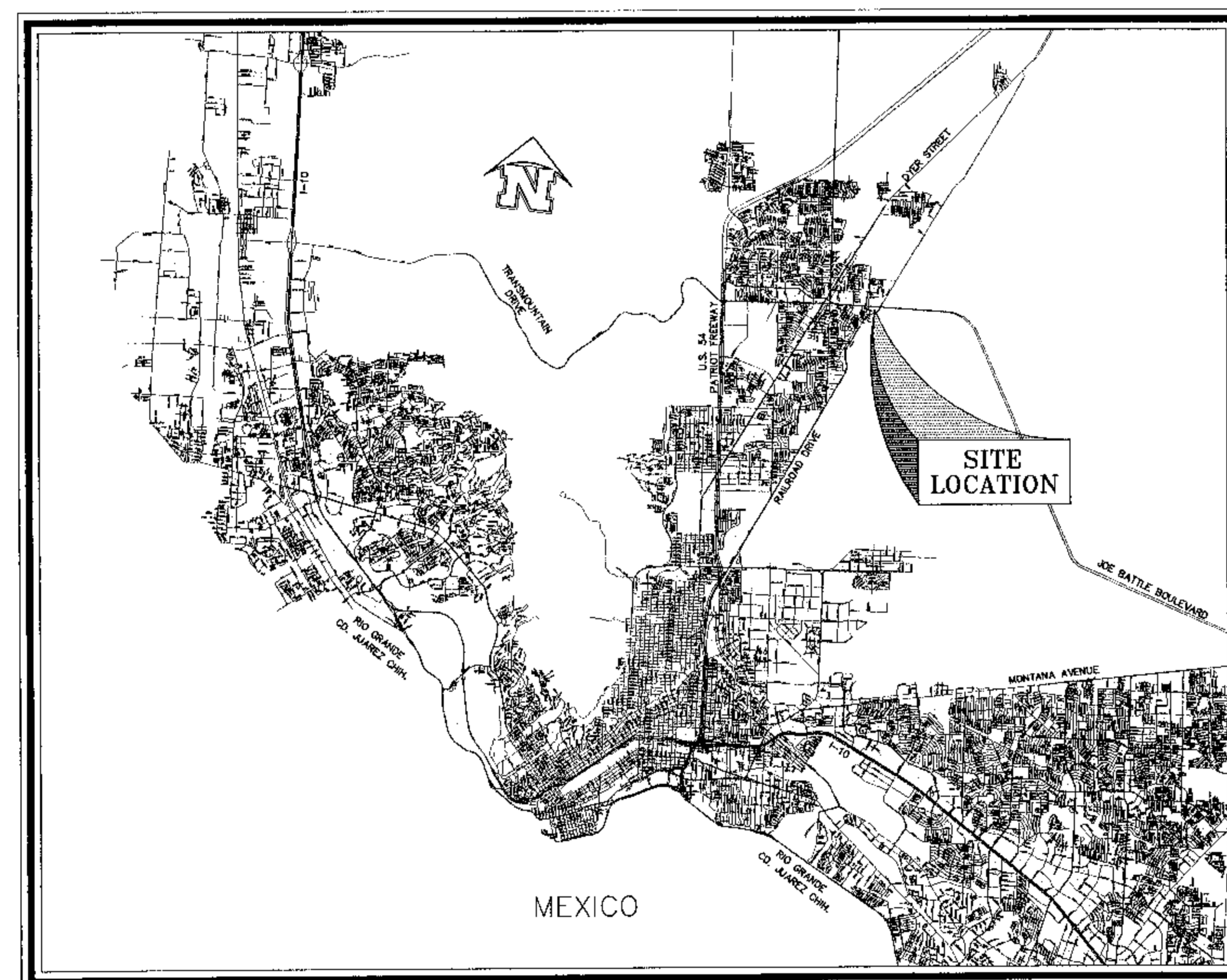

NTS

## LOCATION MAP

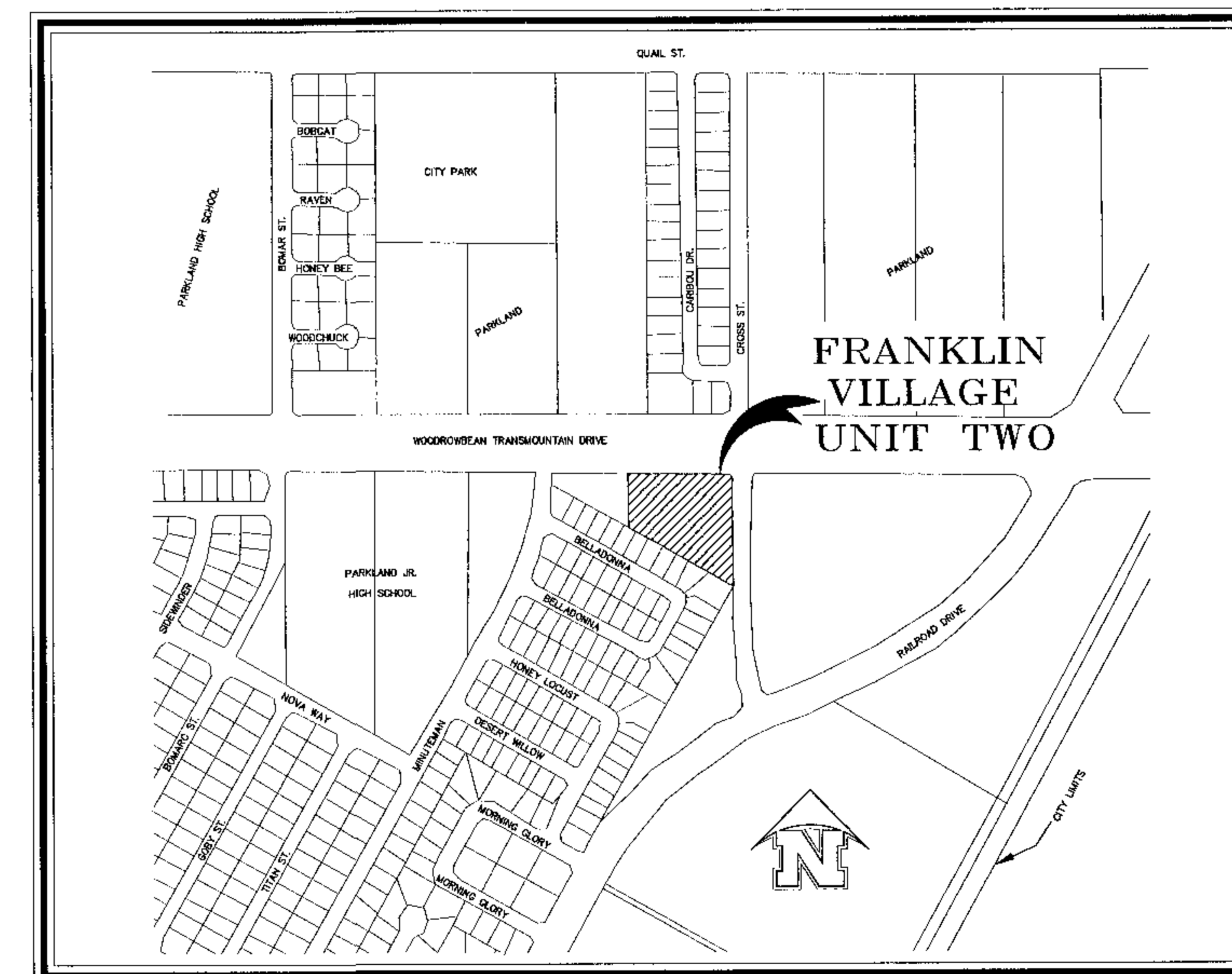

SCALE 1"=600'

DEVELOPMENT SERVICES DEPARTMENT

SITE PLAN REVIEW  
Reviewed For Conformance For Conditions Related To:

- |   |   |
|---|---|
| <ul style="list-style-type: none"> <li>Demolition Only</li> <li>Grading &amp; Drainage</li> <li>Wheelchair Ramps</li> <li>On Site Parking Layout</li> </ul> | <ul style="list-style-type: none"> <li>Sidewalks</li> <li>Driveways</li> <li>Retaining Rock Walls</li> <li>On-Site Ponding of Storm Waters</li> </ul> |
|---|---|

Contractor Must Call 24 Hours Prior To Construction For

BY *James J. Jabme* DATE 11/19/2007



## ATCON

ENGINEERING & SURVEYING  
10950 PELLICANO DRIVE SPACE F, EL PASO, TEXAS 79935  
PH. (915) 592-9878 FAX (915) 592-2134