

CHAVEZ LIGHTBOURN SUBDIVISION

IMPROVEMENT PLANS

INDEX OF SHEETS

SHEET TITLE	SHEET No.
COVER SHEET	1
FINAL PLAT	2
GRADING PLAN	3
DRAINAGE PLAN	4

LOCATION MAP

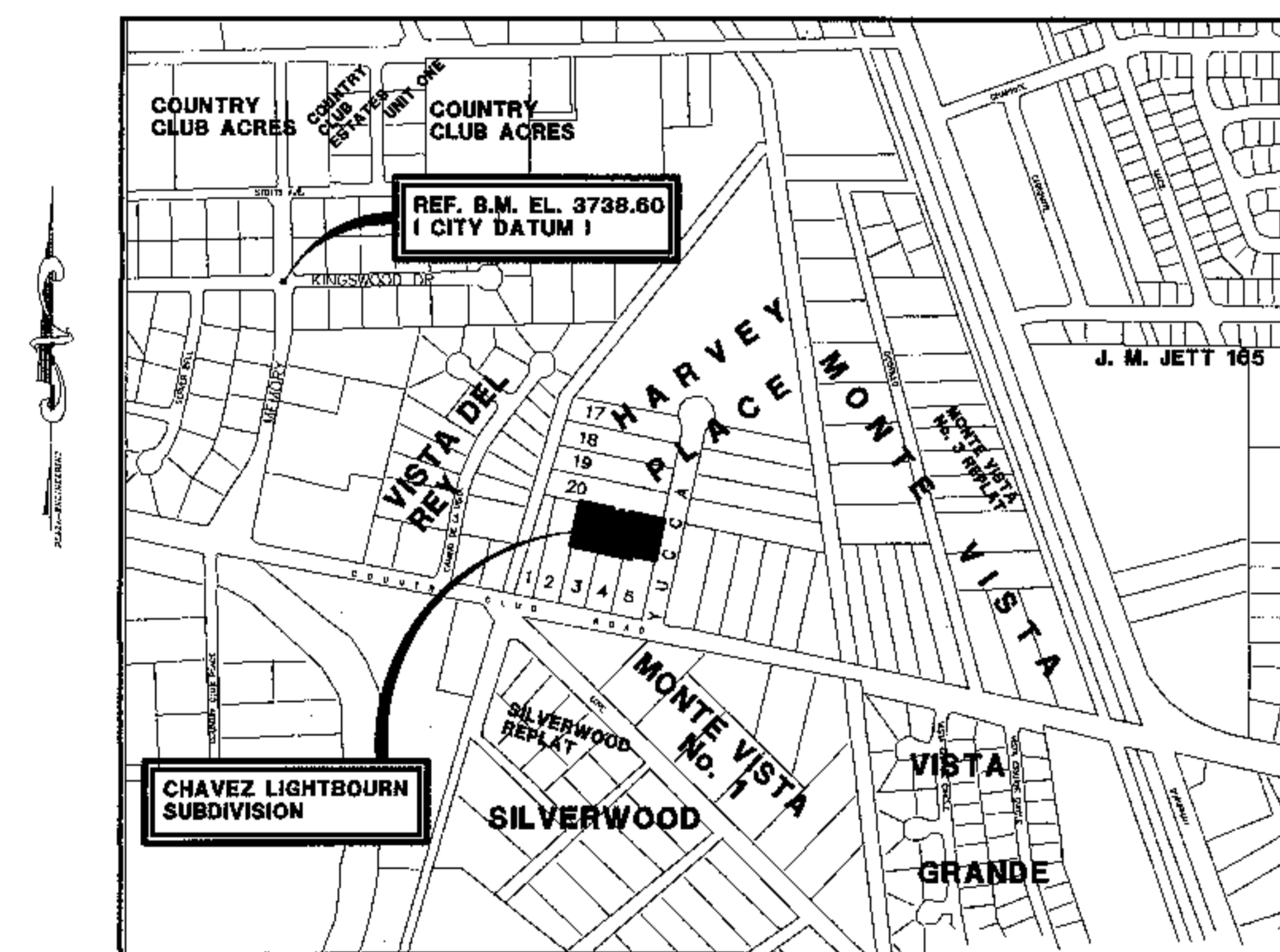

SCALE: 1" = 600'-0"

Civil & Structural Engineering Consultants



Sergio F. Plaza, P.E.
Principal

710 North Saint Vrain Street
El Paso, Texas 79902
(915) 533-8994
(915) 533-8997 Fax
E-mail: PECElPaso@aol.com

P.O. Box 1002
Loveland, Colorado 80539
(970) 227-0015
(970) 663-6353 Fax

**ENGINEERING DEPARTMENT
APPROVED**
for conditions related to:
Grading and drainage
Sidewalks
Driveways
Wheelchair ramps
On-site ponding of storm waters
Retaining truck wall
On-site parking layout
The contractor shall call City Engineering at 541-4970 at least 24 hours prior to construction for inspections. Plans must comply with City of El Paso Municipal Code requirements.
[Signature] Date: 3/30/04



03-23-2004